

Visitor Video Door Entry Systems

You have two options

OBJECTIVE: Resident needs to answer a Video call and remotely open the communal entrance door to visitors.

OPTION 1 HARDWIRED IP VIDEO DOOR ENTRY MONITOR IN FLAT + SMART PHONES ANYWHERE

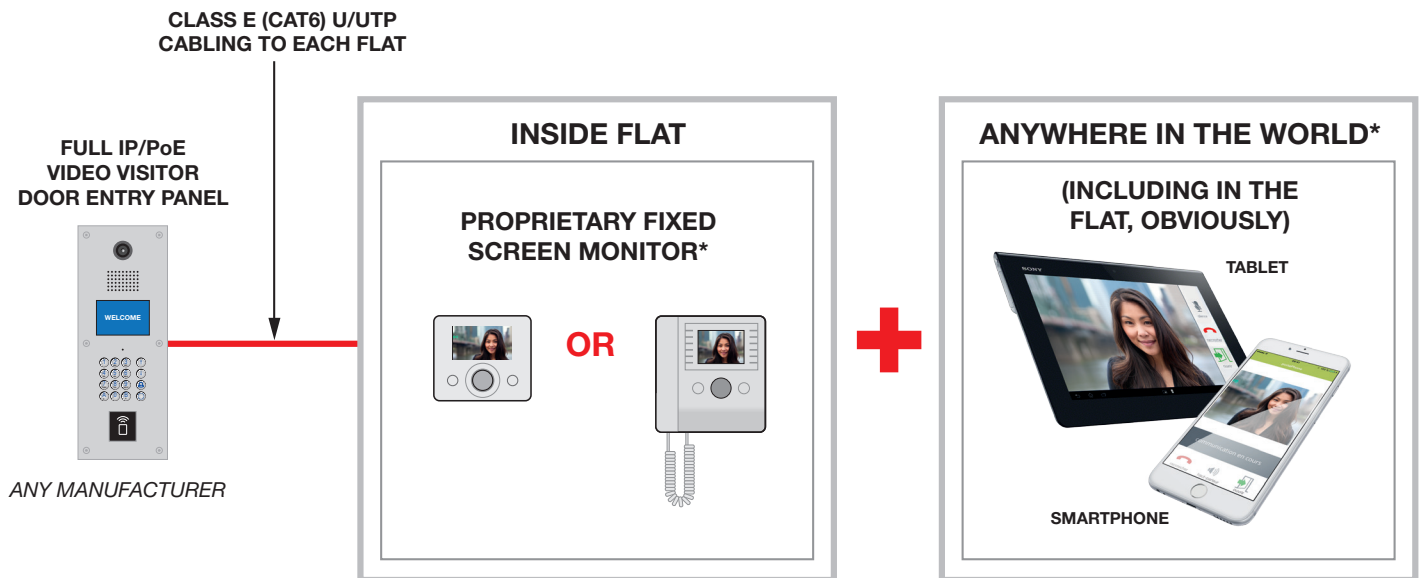

*** FLAT MONITOR AND SMART PHONES / DEVICES –
WHEREVER YOU ARE – ALL RING AT THE SAME TIME.**

Purchase and install a fixed proprietary receiving device (video monitor) in each flat. Requires cabling and Power Over Ethernet (PoE) switches in the communal risers. Finite life as equipment and cabling deteriorates over time until eventual replacement required. Maintenance may need access to flats so higher service charges.

Note: Hardwired video monitor based door entry systems (**non-IP**) that do NOT have automatic forwarding to smart devices are still being installed! However, residents now expect the convenience of smart device connectivity.

IP = Internet Protocol.

Visitor Video Door Entry Systems

You have two options

OPTION 2 SMART TECHNOLOGY 4G/IP/GSM VIDEO DOOR ENTRY

NO CABLING, NO PROPRIETARY EQUIPMENT

SMART TECHNOLOGY
4G/IP/GSM
VISITOR AUDIO-VIDEO
DOOR ENTRY PANEL



ANY MANUFACTURER

INSIDE FLAT + ANYWHERE IN THE WORLD



SMARTPHONE



TABLET

**RESIDENT ANSWERS ON SMART DEVICE,
ANY MIX, WHEREVER THEY HAPPEN TO BE.**

Residents simply use their own smart devices. The call from the visitor door entry panel goes straight to any mix of smart devices: iPhone, Android, iPad, tablet etc. If no answer, the call automatically forwards to 2nd and then 3rd smart devices, telephone numbers etc.

No costs of purchasing and installing proprietary fixed receiving devices. No equipment and cabling deterioration. System improves over time as residents update their own smart devices with better, regular free APP updates (new features etc), constant improvements to BATICONNECT CLOUD platform – all this at no cost to management company.



IPGUARD
4G/IP/GSM SMART
Visitor Door Entry



TOTAL 24/7/365 REAL-TIME
REMOTE MANAGEMENT
OF ALL YOUR SITES
www.baticonnect.com

**Smart technology – App based – Live Video
4G + IP (WIFI) + GSM so future-proof**